

BALL VALVES RK-PROBALL

KH 3T SV (NC), 1/2" - 4", PN63/100

casting lever

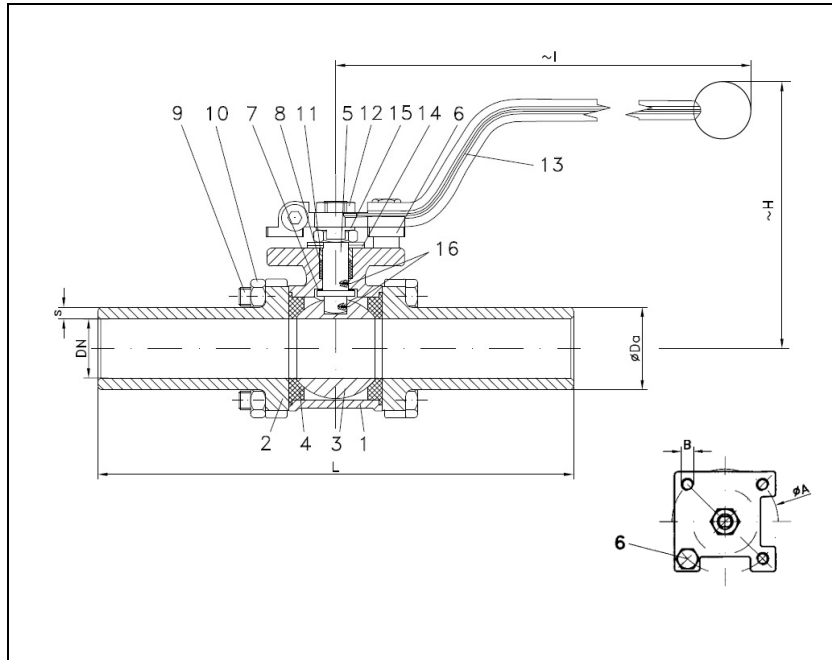

Ball valves RK-Proball KH 3T all sizes are also available with pneumatical, electrical or hydraulic actuators.

No.	Part	Material	Material
1	body	1.0619	1.4408
2	cap	1.0619	1.4408
3	ball		1.4408
4	seat		KFG
5	stem		1.4401
6	stop pin		1.4301
7	washer		KFG
8	stem packing		KF
9	hex. screw		A2-70
10	hex. nut		A2-70
11	thrust washer		1.4301
12	hex. nut		A2-70
13	lever		1.4301
14	plate spring		1.4310
15	locking plate		1.4301
16	antistatic element		1.4401

Ball valve with extended butt weld ends full bore
face to face dimensions acc. to producers standard
butt weld ends acc. to EN 12627

Specification:

Three-piece ball valve, extended butt weld ends acc. to EN 12627, face to face dimensions acc. to producers standard, full bore, body material stainless steel (1.4408) or steel (1.0619), antistatic device, free of non ferrous metals, seat KFG, stem packing KF, disc spring loaded adjustable, top flange DIN EN ISO 5211, approved by PED, certified acc. to GERMAN clean air act VDI 2440, with lever.

Marking: RK-Proball

Types: KH 3T SV (NC)-1.0619

KH 3T SV (NC)-1.4408

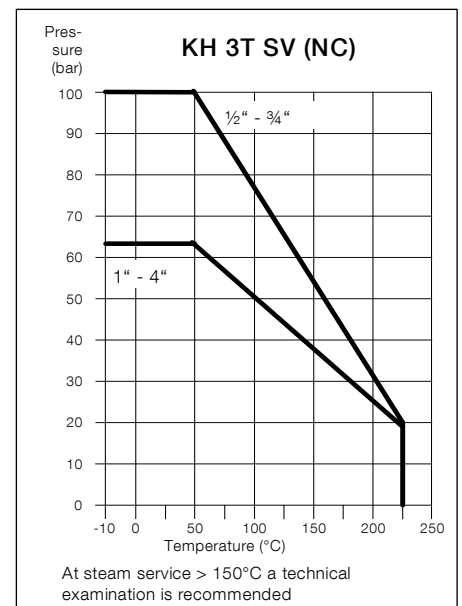

Ordering example:

KH 3T SV (NC), 2", PN 63, 1.4408,

Dimensions

DN mm	DN inch	PN	dimensions (mm)					top flange ISO 5211		Kv-value m³/h	torque Nm	weight kg	
			Ø Da	S	H	I	L	Ø A	B				
15	1/2	100	23.5	4.25	86	169	180	F04	42	M5	10	5	1.0
20	3/4	100	29.0	4.50	93	169	180	F04	42	M5	25	10	1.2
25	1	63	35.7	5.35	105	222	180	F05	50	M6	35	11	1.8
32	1 1/4	63	45.0	6.50	110	222	200	F05	50	M6	46	20	2.8
38	1 1/2	63	51.0	6.50	124	222	200	F05	50	M6	80	26	3.5
49	2	63	62.0	6.50	146	304	210	F07	70	M8	110	30	5.5
65	2 1/2	63	78.0	6.50	170	304	240	F07	70	M8	310	70	10.2
80	3	63	91.0	5.50	176	354	280	F10	102	M10	360	90	14.6
100	4	63	116.3	8.15	207	354	280	F10	102	M10	820	120	27.5

06/2016

Subject to modification.